

... TUS

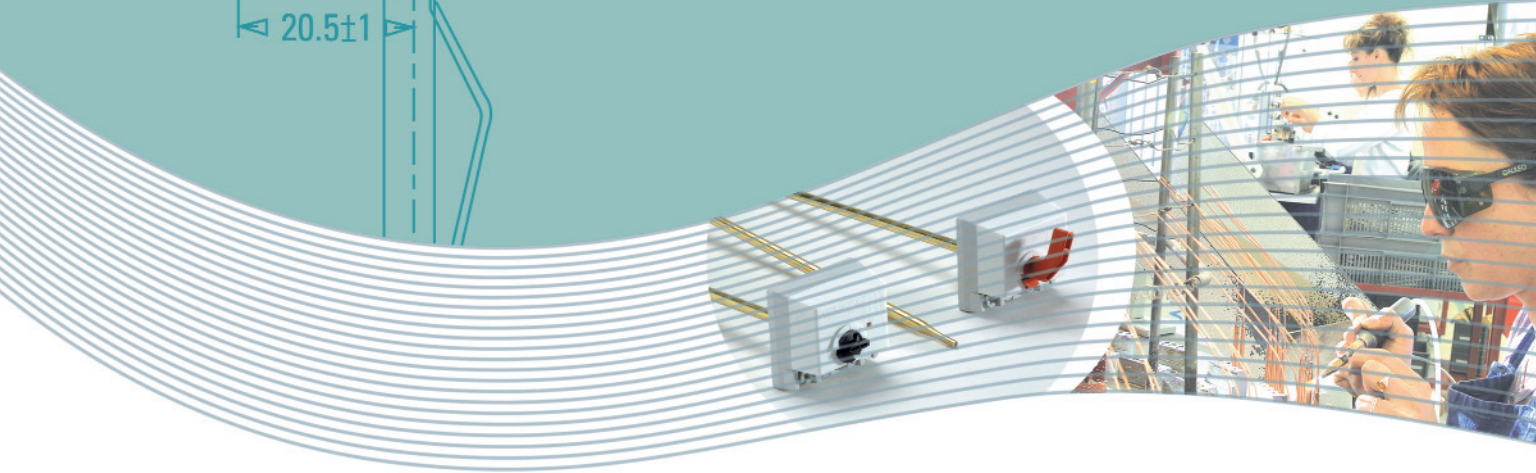

→ DESCRIPTION

Combistat with single pole stem control and single or double pole safety limiter

→ FEATURES

- Independent non self resetting safety function
- Available with single or double pole limiter or as control only
- Multiple mounting possibilities
- Factory pre-set fixed temperature, OEM adjustable or end-user adjustable temperature

→ OPERATION

The differential expansion of the sensing element causes the opening of a snap-action switch in the thermostat head. In case of abnormal temperature rise, a bimetal disc ensures double pole safety. The limiter is manually resettable

TECHNICAL CHARACTERISTICS

	TUS	TUSS	TUSU
Type	Single pole stem control with double pole bimetal safety limiter	Single pole stem control with single pole bimetal safety limiter	Single pole stem control
Temperature range	0°C to 160°C / 32°F to 320°F		
Differential	Approx 5% of the temperature range		
Safety limiter temperature	Fixed 65°C - 120°C / 149°F - 248°F		
Rating	15A - 400V or 20A - 250V		
Material	Brass, invar, bimetal		
Stem length	137, 180, 215, 270, 350 and 450 mm / 5, 7, 8, 11, 14 and 18"		
Sensing element diameter	6 mm / 1/4"		
Maximum head temperature	115°C / 239°F		
Connections	Brass faston or screw terminals		
Approvals	CE, EN60730		

...TUS

TECHNICAL CHARACTERISTICS

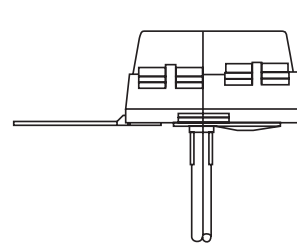
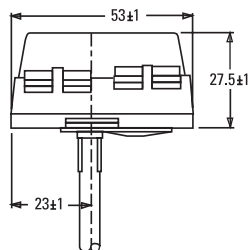
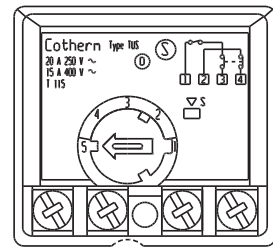
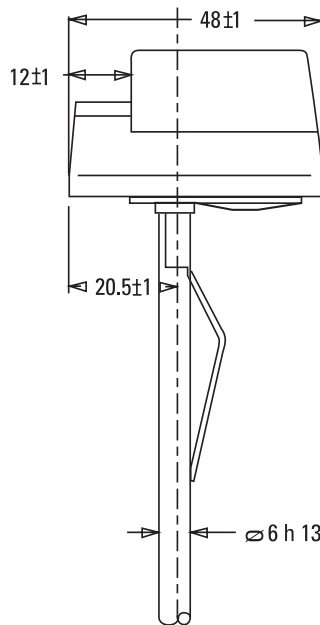
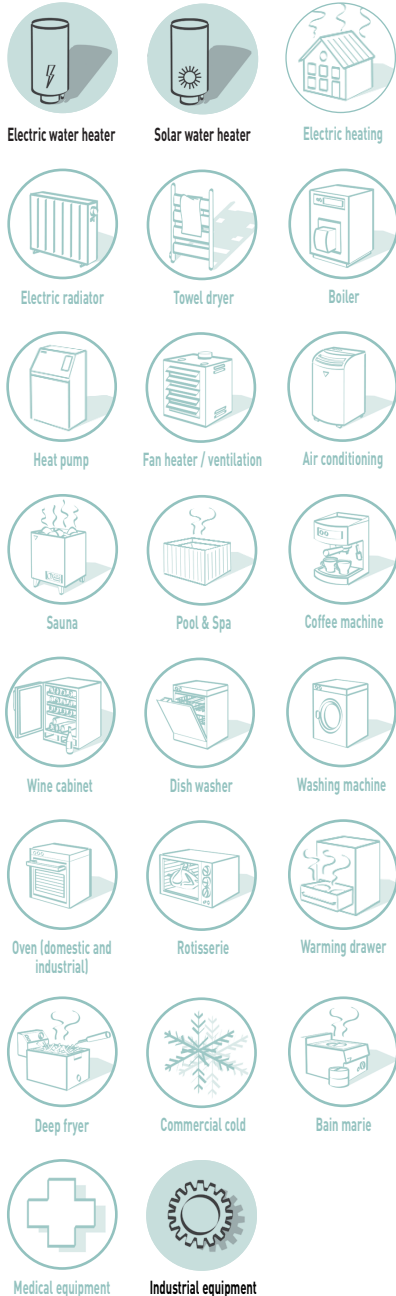

Connexions			
	With screw and plate		Added 45 EXT
	With screw only		AMP added 90°
	Inviolable screw		added right

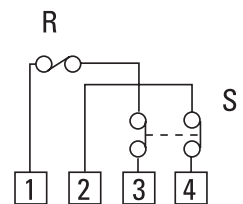

Weight : approx. 110g

COTHERM reserves the right to bring any modifications to our products. We manufacture products according to drawings which serve as contractual documents. We are not responsible for damage resulting from inappropriate installation or use of our product.